

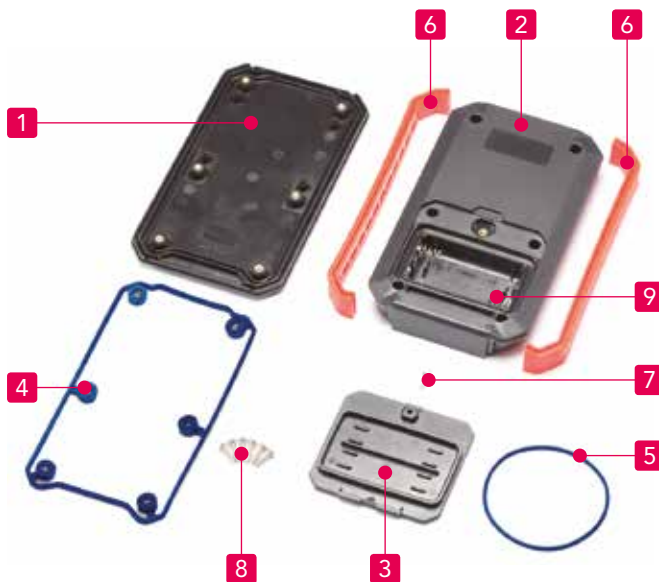

# Serie WH

# Series WH



- Modernes und elegantes Design mit abgeschrägten Kanten.
- Schutzklasse IP67.
- Aus schwer entflammbarem Material ABS UL94V-0.
- 8 verschiedene Batteriefächer verfügbar: AAA x 2, AAA x 3, AAA x 4, AA x 2, AA x 3, AA x 4, AA x 6 und ohne Batteriefach.
- Die TPE Seitengriffe dienen als Fallschutz und ermöglichen eine sichere Handhabung; Seitengriffe erhältlich in fünf verschiedenen Farben.

- Stylish and elegantly designed with chamfered edge construction.
- IP67 class enclosure.
- Manufactured from flame-resistant ABS UL94V-0.
- 8 different internal compartment types are available: AAA x 2, AAA x 3, AAA x 4, AA x 2, AA x 3, AA x 4, AA x 6 and no battery type. Battery compartments have positive (+) / negative (-) pole mark to prevent incorrect insertion.
- The TPE side grips are available in 5 unique colors, and functions as an anti-slip grip pad and drop impact protection.

### Komponenten

Nr.	Bezeichnung	Stück	Material	Farbe / Oberfläche
1	Oberschale	1	ABS UL94V-0	weiß • schwarz
2	Unterschale	1	ABS UL94V-0	weiß • schwarz
3	Batterie Abdeckung (nicht für N-Variante)	1	ABS UL94V-0	weiß • schwarz
4	Dichtung	1	Silikon	N • F2 • F3 • M4 Typ: schwarz M2 Typ: blau M3 • F4 Typ: lichtgrau
5	O-Ring (nicht für N-Variante)	1	Silikon	schwarz • lichtgrau • navy • rot • gelb
6	Seitengriff	2	TPE	schwarz • lichtgrau • navy • rot • gelb
7	Batterie Abdeckung Schraube (nicht für N-Variante)	1	Edelstahl M2.5-6	unbehandelt
8	Schraube	6	Edelstahl M2.5-10	unbehandelt
9	Batteriekontakt (nicht für N-Variante)	1 set	Messing	vernickelt

### Components

No.	Part name	Pcs	Material	Color / Finish
1	Top cover	1	ABS UL94V-0	Off-white • Black
2	Bottom cover	1	ABS UL94V-0	Off-white • Black
3	Battery cover (None for N-type)	1	ABS UL94V-0	Off-white • Black
4	Gasket	1	Silicone	N • F2 • F3 • M4 type: Black M2 type: Blue M3 • F4 type: Light gray
5	O-ring (None for N-type)	1	Silicone	schwarz • lichtgrau • navy • rot • gelb
6	Side grip	2	TPE	Black • Light gray • Navy • Red • Yellow
7	Battery cover screw (None for N-type)	1	Stainless steel M2.5-6	Unfinished
8	Screw	6	Stainless steel M2.5-10	Unfinished
9	Battery contact (None for N-type)	1 set	Brass	Nickel plated

# WH Zubehör

# WH Accessoires



PCB Montageschraube  
PCB mounting screw  
Serie EM-2.3 / Series EM-2.3



Kabelverschraubung  
Cable gland



Abstandsbolzen  
Tapping standoff  
Serie TPS / Series TPS



Neodym Magnet  
Neodymium magnet  
Serie NMG / Series NMG

## Batteriefach Typen - Type Battery Compartments

Type	N None	F2 AAA x 2	F3 AAA x 3	F4 AAA x 4	M2 AA x 2	M3 AA x 3	M4 AA x 4	M6 AA x 6
Batteriefächer Battery compartment								

## Farbvarianten - Color Types

Code	<table border="1"><tr><td>B</td><td>B</td></tr><tr><td>Black</td><td>Black</td></tr></table>	B	B	Black	Black	<table border="1"><tr><td>B</td><td>L</td></tr><tr><td>Black</td><td>Light gray</td></tr></table>	B	L	Black	Light gray	<table border="1"><tr><td>B</td><td>N</td></tr><tr><td>Black</td><td>Navy</td></tr></table>	B	N	Black	Navy	<table border="1"><tr><td>B</td><td>R</td></tr><tr><td>Black</td><td>Red</td></tr></table>	B	R	Black	Red	<table border="1"><tr><td>B</td><td>Y</td></tr><tr><td>Black</td><td>Yellow</td></tr></table>	B	Y	Black	Yellow
B	B																								
Black	Black																								
B	L																								
Black	Light gray																								
B	N																								
Black	Navy																								
B	R																								
Black	Red																								
B	Y																								
Black	Yellow																								
Farbe Color																									
Code	<table border="1"><tr><td>W</td><td>B</td></tr><tr><td>Off-White</td><td>Black</td></tr></table>	W	B	Off-White	Black	<table border="1"><tr><td>W</td><td>L</td></tr><tr><td>Off-White</td><td>Light gray</td></tr></table>	W	L	Off-White	Light gray	<table border="1"><tr><td>W</td><td>N</td></tr><tr><td>Off-White</td><td>Navy</td></tr></table>	W	N	Off-White	Navy	<table border="1"><tr><td>W</td><td>R</td></tr><tr><td>Off-White</td><td>Red</td></tr></table>	W	R	Off-White	Red	<table border="1"><tr><td>W</td><td>Y</td></tr><tr><td>Off-White</td><td>Yellow</td></tr></table>	W	Y	Off-White	Yellow
W	B																								
Off-White	Black																								
W	L																								
Off-White	Light gray																								
W	N																								
Off-White	Navy																								
W	R																								
Off-White	Red																								
W	Y																								
Off-White	Yellow																								
Farbe Color																									

## Bestellnummer / Maße Product no. / Dimensions

■ Bitte vervollständigen Sie die Bestellnummer mit dem Farbcode am Ende.  
■ Please suffix color code at the end of the product number.

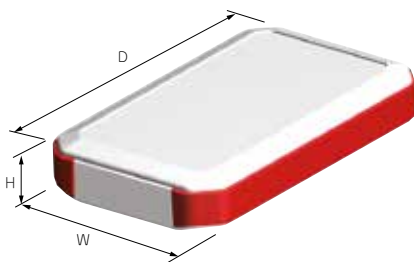

### Technische Daten

Schutzklasse: IP67  
Temperaturbereich: -10°C ~ +60°C  
Empfohlenes Drehmoment:  
0.2N • m ~ 0.3N • m  
(2kgf • cm ~ 3kgf • cm)

### Technical Data

Protection class: IP67  
Operating temperature: -10°C ~ +60°C  
Recommended torque:  
0.2N • m ~ 0.3N • m  
(2kgf • cm ~ 3kgf • cm)

Best-Nr. Product no.	W	H	D	Batteriefach Battery compartment	Gewicht (g) Weight (g)
WH125-20-N -□□	79	20	126	None	101.0
WH125-20-F2 -□□	79	20	126	AAA x 2	102.0
WH125-20-F3 -□□	79	20	126	AAA x 3	109.0
WH125-28-N -□□	79	28	126	None	119.0
WH125-28-F2 -□□	79	28	126	AAA x 2	121.0
WH125-28-F3 -□□	79	28	126	AAA x 3	127.0
WH145-20-N -□□	88	20	146	None	125.5
WH145-20-F4 -□□	88	20	146	AAA x 4	129.5
WH145-25-N -□□	88	25	146	None	137.5
WH145-25-M2 -□□	88	25	146	AA x 2	161.5
WH145-25-M3 -□□	88	25	146	AA x 3	159.5
WH145-33-N -□□	88	33	146	None	162.0
WH145-33-M2 -□□	88	33	146	AA x 2	180.5
WH145-33-M3 -□□	88	33	146	AA x 3	181.5
WH170-25-N -□□	95	25	171	None	169.0
WH170-25-M4 -□□	95	25	171	AA x 4	195.0
WH170-33-N -□□	95	33	171	None	191.0
WH170-33-M4 -□□	95	33	171	AA x 4	220.0
<b>NEW</b> WH190-25-N -□□	126	25	191	None	226.0
<b>NEW</b> WH190-25-M6 -□□	126	25	191	AA x 6	276.0
<b>NEW</b> WH190-33-N -□□	126	33	191	None	252.0
<b>NEW</b> WH190-33-M6 -□□	126	33	191	AA x 6	307.0

WH Maße

WH Dimensions

WH125-20-N / WH125-28-N  
 WH145-20-N / WH145-25-N / WH145-33-N  
 WH170-25-N / WH170-33-N / WH190-25-N / WH190-33-N

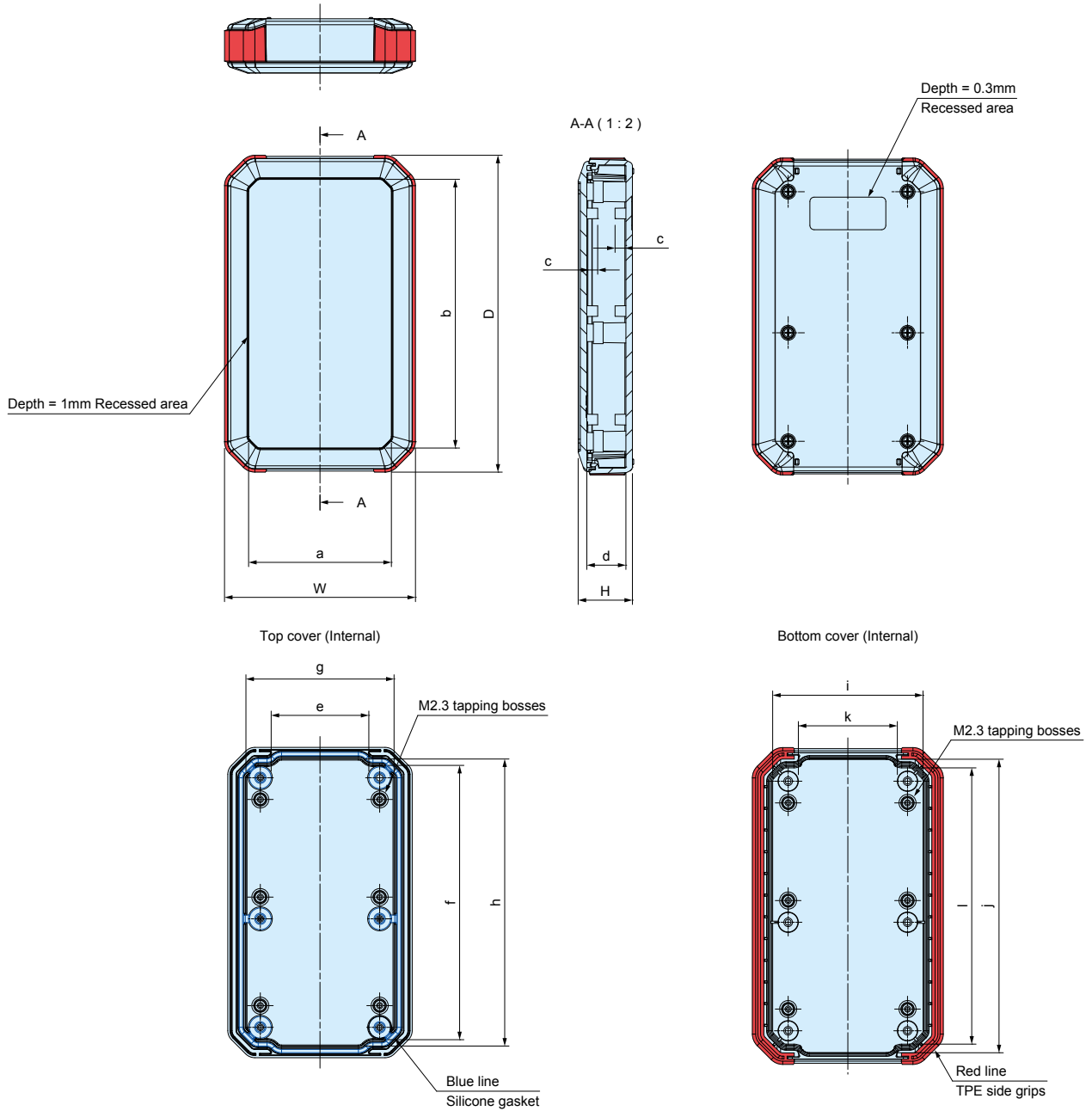

Best-Nr. Product no.	W W	H H	D D	a a	b b	c c	d d	e e	f f	g g	h h	i i	j j	k k	l l
WH125-20-N-□□	79	20	126	58.8	105.8	4	13	39	107	60	112.6	61.6	115.8	39	108
WH125-28-N-□□	79	28	126	58.8	105.8	4	21	39	107	60	112.6	61.1	115.8	39	108
WH145-20-N-□□	88	20	146	65.8	123.8	5	13	45	125.2	68.3	132.3	69.6	135.2	45	127.6
WH145-25-N-□□	88	25	146	65.8	123.8	5	18	45	125.2	68.3	132.3	69.3	135.2	45	127.2
WH145-33-N-□□	88	33	146	65.8	123.8	5	26	45	125.2	68.3	132.3	68.7	135.2	45	126.7
WH170-25-N-□□	95	25	171	69.6	145.6	5	18	51	150	74.4	156	77.3	159.8	50.6	152
WH170-33-N-□□	95	33	171	69.6	145.6	5	26	51	150	74.4	156	76.7	159.8	50.3	151
WH190-25-N-□□	126	25	191	96	161	5	18	81	170.3	105.4	176.4	107.6	180.2	80.2	172.3
WH190-33-N-□□	126	33	191	96	161	5	26	81	170.3	105.4	176.4	107.1	180.3	79.6	171.8

# WH Maße

# WH Dimensions

WH125-20-F2 / WH125-20-F3 / WH125-28-F2 / WH125-28-F3  
 WH145-20-F4 / WH145-25-M2 / WH145-25-M3 / WH145-33-M2 / WH145-33-M3  
 WH170-25-M4 / WH170-33-M4 / WH190-25-M6 / WH190-33-M6

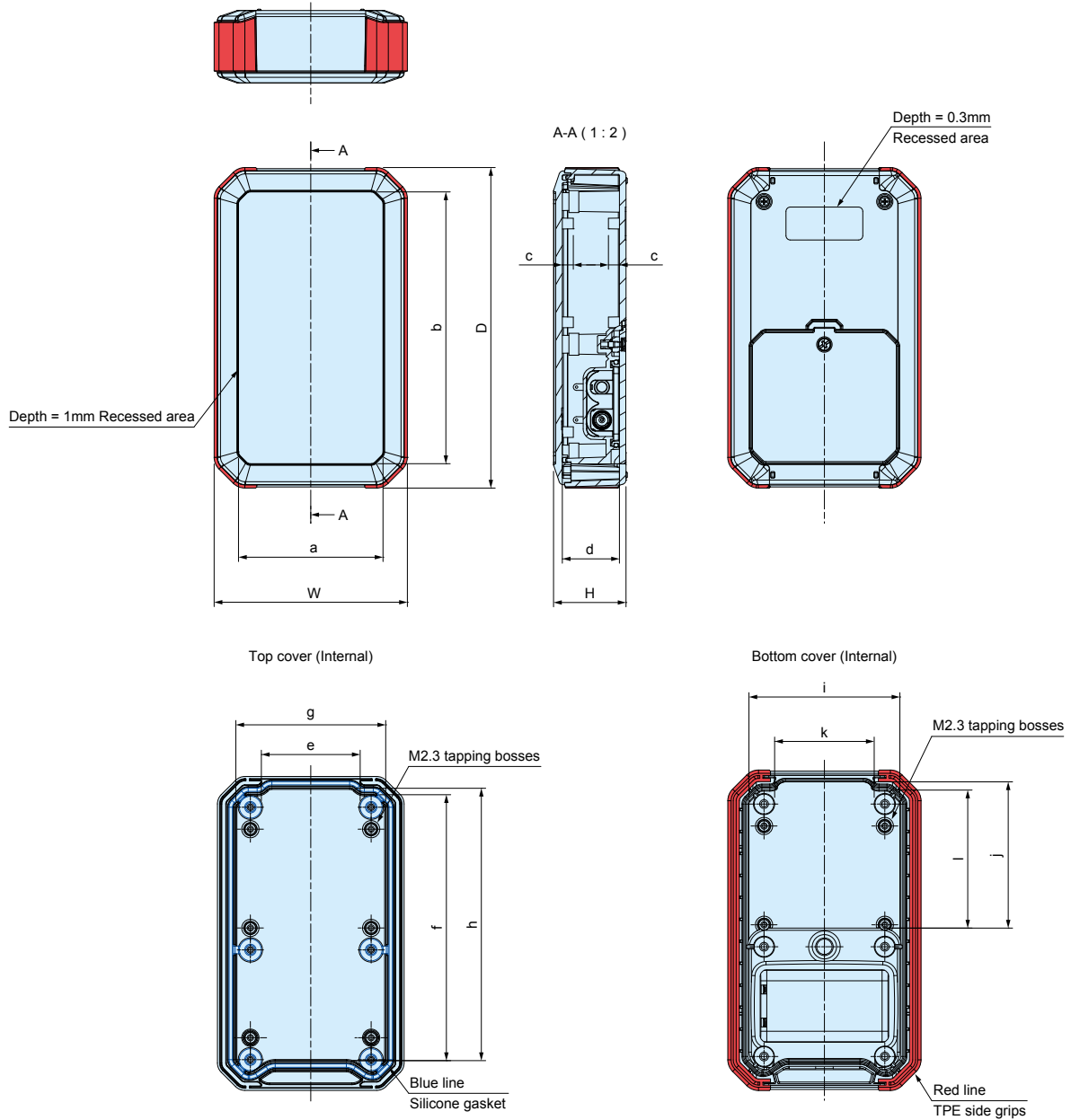

Best-Nr. Product no.	W W	H H	D D	a a	b b	c c	d d	e e	f f	g g	h h	i i	j j	k k	l l
WH125-20- F2-□□	79	20	126	58.8	105.8	4	13	39	104	60	107	61.6	60.4	39	56.7
WH125-20- F3-□□	79	20	126	58.8	105.8	4	13	39	104	60	107	61.6	49.9	39	46.2
WH125-28- F2-□□	79	28	126	58.8	105.8	4	21	39	104	60	107	61.1	60.4	39	56.4
WH125-28- F3-□□	79	28	126	58.8	105.8	4	21	39	104	60	107	61.1	49.9	39	46.0
WH145-20- F4-□□	88	20	146	65.8	123.8	5	13	45	120	68.3	124.1	69.6	51.7	45	47.8
WH145-25-M2-□□	88	25	146	65.8	123.8	5	18	45	120	68.3	124.1	69.3	66.6	45	62.6
WH145-25-M3-□□	88	25	146	65.8	123.8	5	18	45	120	68.3	124.1	69.3	51.6	45	47.6
WH145-33-M2-□□	88	33	146	65.8	123.8	5	26	45	120	68.3	124.1	68.7	66.6	45	62.3
WH145-33-M3-□□	88	33	146	65.8	123.8	5	26	45	120	68.3	124.1	68.7	51.6	45	47.3
WH170-25-M4-□□	95	25	171	69.6	145.6	5	18	51	147.6	74.4	150.4	77.3	71.3	50.6	67.4
WH170-33-M4-□□	95	33	171	69.6	145.6	5	26	51	147.6	74.4	150.4	76.7	71.3	50,3	67.2
WH190-25-M6-□□	126	25	191	96	161	5	18	81	167.3	105.4	170.3	107.6	89.2	80.2	85.2
WH190-33-M6-□□	126	33	191	96	161	5	26	81	167.3	105.4	170.3	107.1	89.1	79.6	84.9