

## Serie EX

Multifunktionales Aluminium-Profilgehäuse

## EX Series

Multi-function extruded aluminium case

Hohe Funktionalität durch die Verwendung von 5 verschiedenen Profilvarianten und identischen Deckelplatten. Für jede Version sind 39 verschiedene Größen verfügbar.

By utilizing 5 different exterior frame types with the same cover, various functions are now possible. 39 different sizes are available for each version.

Version mit Aluminium Deckelplatten  
und Schutzecken  
Aluminium Panel corner guard version



EMV Version mit Schutzecken  
EMC Shielding corner guard version

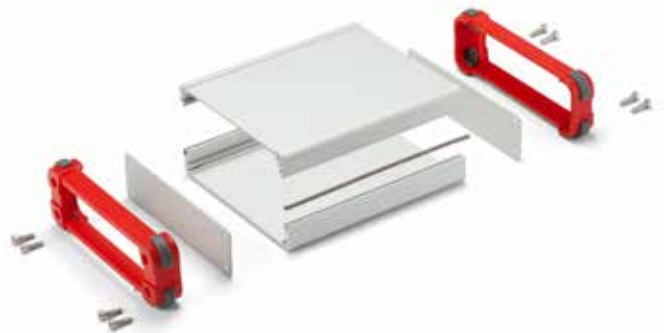

IP65 Version mit Schutzecken  
IP65 Corner guard version



Version mit Kühlkörper  
Heat-sink version



Standard Version  
Standard version



Sonderlängen für alle Versionen verfügbar  
Custom frame length for all versions are available



# 16 FARB VARIANTEN 16 COLOR COMBINATIONS

Erhältlich in 2 Profildfarben und 8 Schutzecken-Farben.  
Available in 2 different body frame and 8 exterior frame colors.



## ANWENDUNGSBEISPIELE - APPLICATION EXAMPLES MEASURING INSTRUMENT



NETWORK / COMMUNICATION BOX

INDUSTRIAL FANLESS EMBEDDED PC



CONTROLLER

DIGITAL AUDIO AMPLIFIER





<b>Technische Daten</b>
Schutzklasse: IP40
<b>Technical Data</b>
Protection class: IP40

**Serie EXP**  
Aluminiumgehäuse mit Schutzecken



**EXP Series**  
Aluminium panel case with corner guard

- Die Schutzecken haben ein schönes Design und dienen als Fallschutz.
- Verfügbar in 39 verschiedenen Standardgrößen und 16 Farbkombinationen.
- Corner guards are designed to be both aesthetically pleasing, and impact resistant.
- Available in 39 different standard sizes with 16 color combinations.

**Bestellnummer / Maße**

Nr.	Best-Nr.	Stück	Material	Farbe / Oberfläche
1	Frontplatten	2	Aluminium A1100 t=1.5	silber • schwarz / eloxiert
2	Oberschale	1	Aluminiumprofil A6063S-T5	silber • schwarz / eloxiert
3	Unterschale	1	Aluminiumprofil A6063S-T5	silber • schwarz / eloxiert
4	Rahmen	2	Polycarbonat-ABS UL94V-0	schwarz • grau / ohne Farbzusatz indigo • navy • limette • gelb • orange • rot / lackiert
5	Schutzecke	8	Silikon	scharz • dunkelgrau
6	Schraube	8	Edelstahl	unbehandelt

**Product no. / Dimensions**

No.	Product no.	Pcs	Material	Color / Finish
1	Panel	2	Aluminium A1100 t=1.5	Silver • Black / Anodized
2	Top cover	1	Extruded aluminium A6063S-T5	Silver • Black / Anodized
3	Bottom cover	1	Extruded aluminium A6063S-T5	Silver • Black / Anodized
4	Exterior frame	2	Polycarbonate-ABS UL94V-0	Black • Gray / Unpainted Indigo • Navy • Lime • Yellow • Orange • Red / Painted
5	Corner guard	8	Silicone	Black • Dark gray
6	Screw	8	Stainless steel	Unfinished

**Farbvarianten**  
**Color Types**

Schwarze und graue Rahmen sind ohne Farbzusatz; alle anderen Rahmen werden lackiert.  
Black and gray exterior frames are unpainted; other colored exterior frames are painted.

<b>Farbcode</b> <b>Color code</b>	S B silber / schwarz S B Silver / Black	S G silber / grau S G Silver / Gray	S I silber / indigo S I Silver / Indigo	S N silber / navy S N Silver / Navy
<b>Farbe</b> <b>Color</b>				
<b>Farbcode</b> <b>Color code</b>	S L silber / limette S L Silver / Lime	S Y silber / gelb S Y Silver / Yellow	S O silber / orange S O Silver / Orange	S R silber / rot S R Silver / Red
<b>Farbe</b> <b>Color</b>				
<b>Farbcode</b> <b>Color code</b>	B B schwarz / schwarz B B Black / Black	B G schwarz / grau B G Black / Gray	B I schwarz / indigo B I Black / Indigo	B N schwarz / navy B N Black / Navy
<b>Farbe</b> <b>Color</b>				
<b>Farbcode</b> <b>Color code</b>	B L schwarz / limette B L Black / Lime	B Y schwarz / gelb B Y Black / Yellow	B O schwarz / orange B O Black / Orange	B R schwarz / rot B R Black / Red
<b>Farbe</b> <b>Color</b>				

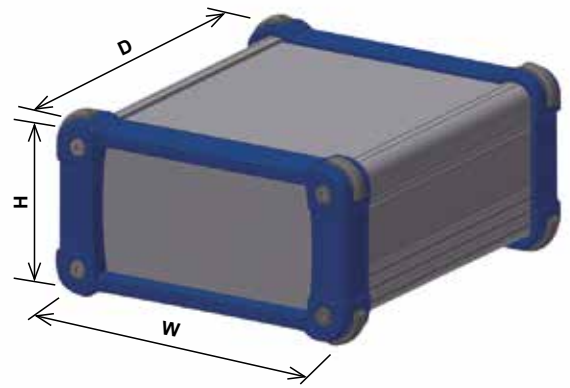
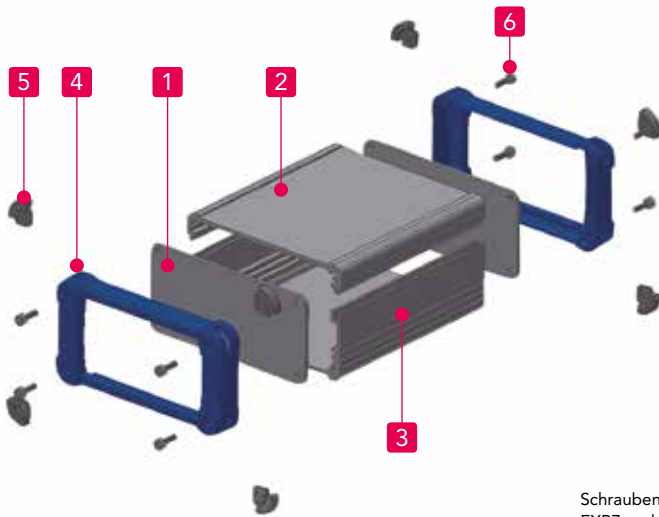

Schrauben inklusive  
 EXP7 und EXP9 Serie : M2.5-8 x 8 Stück  
 EXP11 und EXP15 Serie : M3-10 x 8 Stück  
 ※Sechskantschlüssel inbegriffen.

Included screws  
 EXP7 and EXP9 series : M2.5-8 x 8 pcs  
 EXP11 and EXP15 series : M3-10 x 8 pcs  
 ※Hexagonal wrench included.

**Bestellnummer / Maße**  
**Product no. / Dimensions**

■ Bitte vervollständigen Sie die Bestellnummer mit dem Farbcode am Ende.  
 ■ Please suffix color code at the end of the product number.

Best-Nr. - Product no.	W	H	D
EXP 7- 3- 6□□	69	34	60
EXP 7- 3- 9□□	69	34	87
EXP 7- 3-11□□	69	34	110
EXP 7- 4- 6□□	69	44	60
EXP 7- 4- 9□□	69	44	87
EXP 7- 4-11□□	69	44	110
EXP 7- 6- 6□□	69	59	60
EXP 7- 6- 9□□	69	59	87
EXP 7- 6-11□□	69	59	110
EXP 9- 4- 7□□	89	39	70
EXP 9- 4-10□□	89	39	100
EXP 9- 4-13□□	89	39	130
EXP 9- 5- 7□□	89	49	70
EXP 9- 5-10□□	89	49	100
EXP 9- 5-13□□	89	49	130
EXP 9- 6- 7□□	89	64	70
EXP 9- 6-10□□	89	64	100
EXP 9- 6-13□□	89	64	130
EXP12- 4- 9□□	116	41	90
EXP12- 4-13□□	116	41	130
EXP12- 4-18□□	116	41	176
EXP12- 6- 9□□	116	56	90
EXP12- 6-13□□	116	56	130
EXP12- 6-18□□	116	56	176
EXP12- 7- 9□□	116	71	90
EXP12- 7-13□□	116	71	130
EXP12- 7-18□□	116	71	176
EXP15- 5-11□□	151	46	110
EXP15- 5-15□□	151	46	150
EXP15- 5-20□□	151	46	200
EXP15- 6-11□□	151	61	110
EXP15- 6-15□□	151	61	150
EXP15- 6-20□□	151	61	200
EXP15- 8-11□□	151	81	110
EXP15- 8-15□□	151	81	150
EXP15- 8-20□□	151	81	200
EXP15-10-11□□	151	101	110
EXP15-10-15□□	151	101	150
EXP15-10-20□□	151	101	200

■ Sonderlängen sind ebenfalls möglich. - ■ Custom length is available.



Technische Daten
Schutzklasse: IP40

Technical Data
Protection class: IP40



## Serie EXPE EXPE Series

EMV-geschütztes Aluminiumgehäuse mit Schutzecken Aluminium EMC shield case with corner guard

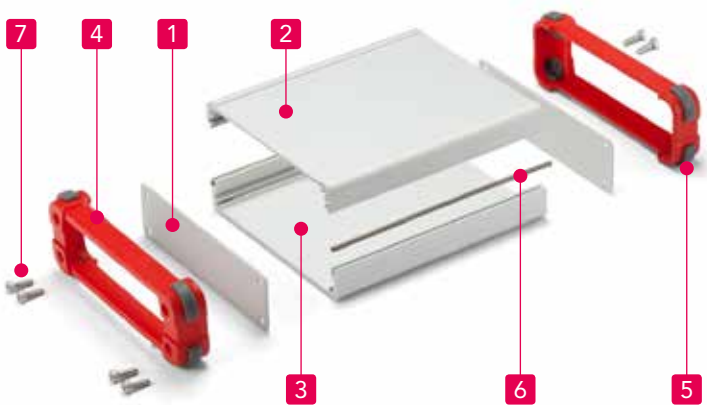

- EMV – Schutz wird erreicht durch unbehandelte, leitfähige Oberflächen auf der Innenseite der Profile und leitfähige Dichtungen.
- Die Schutzecken haben ein schönes Design und dienen als Fallschutz.
- Verfügbar in 39 verschiedenen Standardgrößen und 8 unterschiedlichen Farbkombinationen.
- EMC shielding is achieved by covering the unfinished inner sides of the top/bottom covers and fabric-over-foam gaskets in contact with one another.
- Corner guards are designed to be both aesthetically pleasing, and strong against impact.
- Available in 39 different sizes and 8 different color combinations.

Schrauben inklusive  
 EXPE7 und EXPE9 Serie : M2.5-8 x 8 Stück  
 EXPE11 und EXPE15 Serie : M3-10 x 8 Stück  
 ※Sechskantschlüssel inbegriffen.

Included screws  
 EXPE7 and EXPE9 series : M2.5-8 x 8 pcs  
 EXPE11 and EXPE15 series : M3-10 x 8 pcs  
 ※Hexagonal wrench included.

**Komponenten**

Nr.	Bezeichnung	Stück	Material	Farbe / Oberfläche
1	Frontplatten	2	Aluminium A1100 t=1.5	silber (außen) : unbehandelt (innen)
2	Oberschale	1	Aluminiumprofil A6063S-T5	silber (außen) : unbehandelt (innen)
3	Unterschale	1	Aluminiumprofil A6063S-T5	silber (außen) : unbehandelt (innen)
4	Rahmen	2	Polycarbonat-ABS UL94V-0	schwarz • grau / unbemalt indigo • navy • limette • gelb • orange • rot / lackiert
5	Schutzecke	8	Silikon	scharz • dunkelgrau
6	Leitfähige Schaumstoffdichtung	2	leitfähige TPE Dichtung	metallic grau
7	Schraube	8	Edelstahl	unbehandelt

**Components**

No.	Part name	Pcs	Material	Color / Finish
1	Panel	2	Aluminium A1100 t=1.5	Silver / Anodized (outside) : Unfinished (inside)
2	Top cover	1	Extruded aluminium A6063S-T5	Silver / Painted (outside) : Unfinished (inside)
3	Bottom cover	1	Extruded aluminium A6063S-T5	Silver / Painted (outside) : Unfinished (inside)
4	Exterior frame	2	Polycarbonate-ABS UL94V-0	Black • Gray / Unpainted Indigo • Navy • Lime • Yellow • Orange • Red / Painted
5	Corner guard	8	Silicone	Black • Dark gray
6	Fabric-over-foam gasket	2	Conductive fabric : TPE	Metallic gray
7	Screw	8	Stainless steel	Unfinished

**Farbvarianten  
Color Types**

Schwarze und graue Rahmen sind ohne Farbzusatz; alle anderen Rahmen werden lackiert.  
 Black and gray exterior frames are unpainted; other colored exterior frames are painted.

Farbcode Color code	S B silber / schwarz S B Silver / Black	S G silber / grau S G Silver / Gray	S I silber / indigo S I Silver / Indigo	S N silber / navy S N Silver / Navy
Farbe Color				
Farbcode Color code	S L silber / limette S L Silver / Lime	S Y silber / gelb S Y Silver / Yellow	S O silber / orange S O Silver / Orange	S R silber / rot S R Silver / Red
Farbe Color				

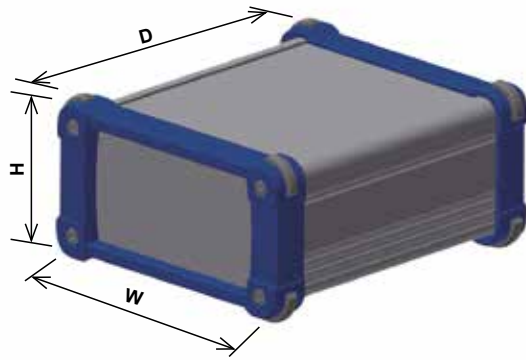

**Bestellnummer / Maße**  
**Product no. / Dimensions**

■ Bitte vervollständigen Sie die Bestellnummer mit dem Farbcode am Ende.  
■ Please suffix color code at the end of the product number.

Best-Nr. - Product no.	W	H	D
EXPE 7- 3- 6□□	69	34	60
EXPE 7- 3- 9□□	69	34	87
EXPE 7- 3-11□□	69	34	110
EXPE 7- 4- 6□□	69	44	60
EXPE 7- 4- 9□□	69	44	87
EXPE 7- 4-11□□	69	44	110
EXPE 7- 6- 6□□	69	59	60
EXPE 7- 6- 9□□	69	59	87
EXPE 7- 6-11□□	69	59	110
EXPE 9- 4- 7□□	89	39	70
EXPE 9- 4-10□□	89	39	100
EXPE 9- 4-13□□	89	39	130
EXPE 9- 5- 7□□	89	49	70
EXPE 9- 5-10□□	89	49	100
EXPE 9- 5-13□□	89	49	130
EXPE 9- 6- 7□□	89	64	70
EXPE 9- 6-10□□	89	64	100
EXPE 9- 6-13□□	89	64	130
EXPE12- 4- 9□□	116	41	90
EXPE12- 4-13□□	116	41	130
EXPE12- 4-18□□	116	41	176
EXPE12- 6- 9□□	116	56	90
EXPE12- 6-13□□	116	56	130
EXPE12- 6-18□□	116	56	176
EXPE12- 7- 9□□	116	71	90
EXPE12- 7-13□□	116	71	130
EXPE12- 7-18□□	116	71	176
EXPE15- 5-11□□	151	46	110
EXPE15- 5-15□□	151	46	150
EXPE15- 5-20□□	151	46	200
EXPE15- 6-11□□	151	61	110
EXPE15- 6-15□□	151	61	150
EXPE15- 6-20□□	151	61	200
EXPE15- 8-11□□	151	81	110
EXPE15- 8-15□□	151	81	150
EXPE15- 8-20□□	151	81	200
EXPE15-10-11□□	151	101	110
EXPE15-10-15□□	151	101	150
EXPE15-10-20□□	151	101	200

**Installation der EMV-Dichtung - How to install a shield gasket**



■ Legen Sie die Dichtung in die offene Nut der Profilerterseite.  
■ Insert fabric-over-foam gasket into the joint-grooves on the bottom cover.

■ Beachten Sie bitte, dass auf beiden Seiten die Dichtung etwas übersteht, damit ein Kontakt zu den Frontplatten hergestellt werden kann.  
■ Ensure that a small portion of the fabric-over-foam gasket protrudes out in order to maintain a connection with the end panels.



**Serie EXW**  
IP65 Aluminiumgehäuse mit Schutzecken



**EXW Series**  
IP 65 aluminium case with corner guard

- Die Schutzart IP65 wird erreicht durch Dichtungen zwischen den Profilmuten und Frontplatten.
- Verfügbar in 39 verschiedenen Standardgrößen und 6 unterschiedlichen Farbkombinationen.
- IP65 is made possible by sealing between top & bottom covers and end panels with gaskets.
- Available in 39 different standard sizes and 6 color combinations by 2 body frame and 3 end panel colors.

Technische Daten
Schutzklasse: IP65

Technical Data
Protection class: IP65

Schrauben inklusive  
EXW7 und EXW9 Serie : M2.5-8 x 8 Stück  
EXW12 und EXW15 Serie : M3-10 x 8 Stück  
※Sechskantschlüssel inbegriffen.

Included screws  
EXW7 and EXW9 series : M2.5-8 x 8 pcs  
EXW12 and EXW15 series : M3-10 x 8 pcs  
※Hexagonal wrench included.

**Komponenten**

Nr.	Bezeichnung	Stück	Material	Farbe / Oberfläche
1	Frontplatten	2	Polycarbonat-ABS UL94V-0	schwarz • grau / ohne Farbzusatz navy / lackiert
2	Oberschale	1	Aluminiumprofil A6063S-T5	silber • schwarz / eloxiert
3	Unterschale	1	Aluminiumprofil A6063S-T5	silber • schwarz / eloxiert
4	Frontplattendichtung	2	Silikon	dunkelgrau • schwarz
5	Profildichtung	2	Silikon	hellgrau
6	Schraube	8	Edelstahl	unbehandelt

**Components**

No.	Part name	Pcs	Material	Color / Finish
1	End panel	2	Polycarbonate-ABS UL94V-0	Black • Gray / Unpainted Navy / Painted
2	Top cover	1	Extruded aluminium A6063S-T5	Silver • Black / Anodized
3	Bottom cover	1	Extruded aluminium A6063S-T5	Silver • Black / Anodized
4	Panel gasket	2	Silicone	Dark gray • Black
5	Cover gasket	2	Silicone	White gray
6	Screw	8	Stainless steel	Unfinished

**Farbvarianten  
Color Types**

Schwarze und graue Rahmen sind ohne Farbzusatz; alle anderen Rahmen werden lackiert.  
Black and gray end panels are unpainted; navy end panel is painted.

Farbcode Color code	S B silber / schwarz S B Silver / Black	S G silber / grau S G Silver / Gray	S N silber / navy S N Silver / Navy
Farbe Color			
Farbcode Color code	B B schwarz / schwarz B B Black / Black	B G schwarz / grau B G Black / Gray	B N schwarz / navy B N Black / Navy
Farbe Color			

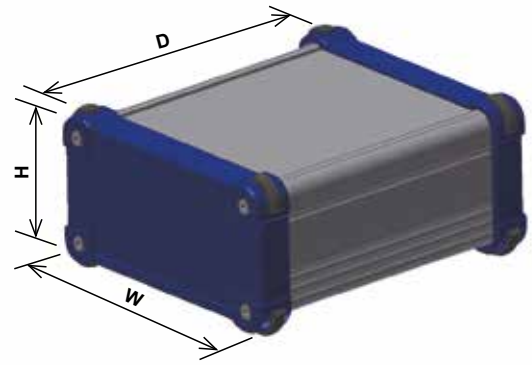
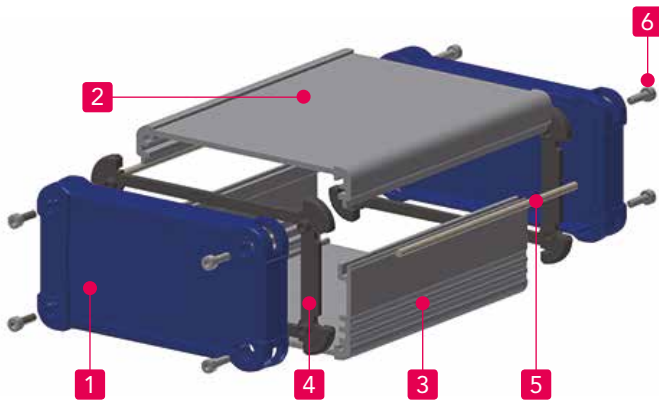

**Bestellnummer / Maße**  
**Product no. / Dimensions**

■ Bitte vervollständigen Sie die Bestellnummer mit dem Farbcode am Ende.  
■ Please suffix color code at the end of the product number.

Best-Nr. - Product no.	W	H	D
EXW 7- 3- 6□□	69	34	58
EXW 7- 3- 9□□	69	34	85
EXW 7- 3-11□□	69	34	108
EXW 7- 4- 6□□	69	44	58
EXW 7- 4- 9□□	69	44	85
EXW 7- 4-11□□	69	44	108
EXW 7- 6- 6□□	69	59	58
EXW 7- 6- 9□□	69	59	85
EXW 7- 6-11□□	69	59	108
EXW 9- 4- 7□□	89	39	69
EXW 9- 4-10□□	89	39	99
EXW 9- 4-13□□	89	39	129
EXW 9- 5- 7□□	89	49	69
EXW 9- 5-10□□	89	49	99
EXW 9- 5-13□□	89	49	129
EXW 9- 6- 7□□	89	64	69
EXW 9- 6-10□□	89	64	99
EXW 9- 6-13□□	89	64	129
EXW12- 4- 9□□	116	41	88
EXW12- 4-13□□	116	41	128
EXW12- 4-18□□	116	41	174
EXW12- 6- 9□□	116	56	88
EXW12- 6-13□□	116	56	128
EXW12- 6-18□□	116	56	174
EXW12- 7- 9□□	116	71	88
EXW12- 7-13□□	116	71	128
EXW12- 7-18□□	116	71	174
EXW15- 5-11□□	151	46	107
EXW15- 5-15□□	151	46	147
EXW15- 5-20□□	151	46	197
EXW15- 6-11□□	151	61	107
EXW15- 6-15□□	151	61	147
EXW15- 6-20□□	151	61	197
EXW15- 8-11□□	151	81	107
EXW15- 8-15□□	151	81	147
EXW15- 8-20□□	151	81	197
EXW15-10-11□□	151	101	107
EXW15-10-15□□	151	101	147
EXW15-10-20□□	151	101	197

■ Sonderlängen sind ebenfalls möglich. - ■ Custom length is available.

**Installation der EMV-Dichtung - How to install a cover gasket**



■ Legen Sie die Dichtung in die offene Nut der Profilerunterseite.  
■ Insert cover gasket into the joint-grooves on the bottom cover.



■ Beachten Sie bitte, dass auf beiden Seiten die Dichtung etwas übersteht, damit ein Kontakt zu den Frontplatten hergestellt werden kann.  
■ Ensure that a small portion of the cover gasket protrudes out in order to maintain a seal with the panel gasket for IP65 protection.



**Technische Daten**

Schutzklasse: IP40

**Technical Data**

Protection class: IP40



## Serie EX

Aluminium-Profilgehäuse



## EX Series

Extruded aluminium case



- Aluminiumgehäuse aus extrudierten Profilen mit schönem Design.
- Verfügbar in 4 Farbkombinationen.
- Edle Oberflächenbeschaffenheit mit angefasten Deckelplatten.
- Geeignet für industrielle Produkte und Audio Anwendungen.

- Simple yet beautifully designed aluminium extrusion enclosure.
- Selectable in 4 different color combinations.
- Beautiful high-end finish is achieved by having a chamfered edge panel.
- Suitable for industrial and audio interface equipments.

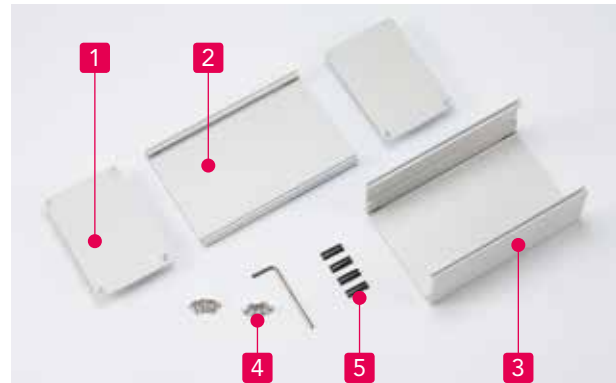
**Komponenten**

Nr.	Bezeichnung	Stück	Material	Farbe / Oberfläche
1	Frontplatten	2	Aluminium A1050P	silber • schwarz / eloxiert
2	Oberschale	1	Aluminiumprofil A6063S-T5	silber • schwarz / eloxiert
3	Unterschale	1	Aluminiumprofil A6063S-T5	silber • schwarz / eloxiert
4	Schraube	8	Edelstahl	unbehandelt
5	GummifüÙe	4	Polyurethan	schwarz

**Components**

No.	Part name	Pcs	Material	Color / Finish
1	End panel	2	Aluminium A1050P	Silver • Black / Anodized
2	Top cover	1	Extruded aluminium A6063S-T5	Silver • Black / Anodized
3	Bottom cover	1	Extruded aluminium A6063S-T5	Silver • Black / Anodized
4	Screw	8	Stainless steel	Unfinished
5	Rubber feet	4	Polyurethane	Black

**Farbvarianten - Color Types**

Farbcode Color code	S S silber / silber S S Silver / Silver	S B silber / schwarz S B Silver / Black	B S schwarz / silber B S Black / Silver	B B schwarz / schwarz B B Black / Black
Farbe Color				

# EX Maße

# EX Dimensions

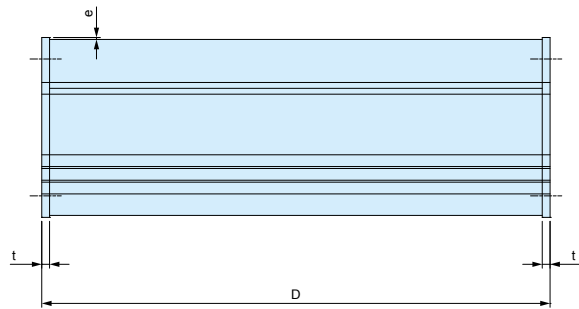
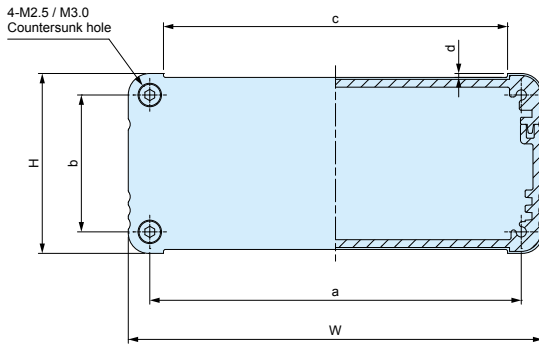

Schrauben inklusive  
EX6 und EX8 Serie : M2.5-8 x 8 Stück  
EX11 und EX14 Serie : M3-8 x 8 Stück  
※Sechskantschlüssel inbegriffen.

Included screws  
EX6 and EX8 series : M2.5-8 x 8 pcs  
EX11 and EX14 series : M3-8 x 8 pcs  
※Hexagonal wrench included.

## Bestellnummer / Maße Product no. / Dimensions

■ Bitte vervollständigen Sie die Bestellnummer mit dem Farbcode am Ende.  
■ Please suffix color code at the end of the product number.

Best-Nr. Product no.	W	H	D	a	b	c	d	e	t
EX 6- 3- 5□□	60.6	25.6	50	52	17	45.2	0.9	0.3	2
EX 6- 3- 8□□	60.6	25.6	77	52	17	45.2	0.9	0.3	2
EX 6- 3-10□□	60.6	25.6	100	52	17	45.2	0.9	0.3	2
EX 6- 4- 5□□	60.6	35.6	50	52	27	45.2	0.9	0.3	2
EX 6- 4- 8□□	60.6	35.6	77	52	27	45.2	0.9	0.3	2
EX 6- 4-10□□	60.6	35.6	100	52	27	45.2	0.9	0.3	2
EX 6- 5- 5□□	60.6	50.6	50	52	42	45.2	0.9	0.3	2
EX 6- 5- 8□□	60.6	50.6	77	52	42	45.2	0.9	0.3	2
EX 6- 5-10□□	60.6	50.6	100	52	42	45.2	0.9	0.3	2
EX 8- 3- 6□□	80.6	30.6	60	72	22	65.2	0.9	0.3	2
EX 8- 3- 9□□	80.6	30.6	90	72	22	65.2	0.9	0.3	2
EX 8- 3-12□□	80.6	30.6	120	72	22	65.2	0.9	0.3	2
EX 8- 4- 6□□	80.6	40.6	60	72	32	65.2	0.9	0.3	2
EX 8- 4- 9□□	80.6	40.6	90	72	32	65.2	0.9	0.3	2
EX 8- 4-12□□	80.6	40.6	120	72	32	65.2	0.9	0.3	2
EX 8- 6- 6□□	80.6	55.6	60	72	47	65.2	0.9	0.3	2
EX 8- 6- 9□□	80.6	55.6	90	72	47	65.2	0.9	0.3	2
EX 8- 6-12□□	80.6	55.6	120	72	47	65.2	0.9	0.3	2
EX11- 3- 8□□	106	31	79	95	20	87	1	0.5	2.5
EX11- 3-12□□	106	31	119	95	20	87	1	0.5	2.5
EX11- 3-16□□	106	31	165	95	20	87	1	0.5	2.5
EX11- 5- 8□□	106	46	79	95	35	87	1	0.5	2.5
EX11- 5-12□□	106	46	119	95	35	87	1	0.5	2.5
EX11- 5-16□□	106	46	165	95	35	87	1	0.5	2.5
EX11- 6- 8□□	106	61	79	95	50	87	1	0.5	2.5
EX11- 6-12□□	106	61	119	95	50	87	1	0.5	2.5
EX11- 6-16□□	106	61	165	95	50	87	1	0.5	2.5
EX14- 4-10□□	141	36	98	130	25	122	1	0.5	2.5
EX14- 4-14□□	141	36	138	130	25	122	1	0.5	2.5
EX14- 4-19□□	141	36	188	130	25	122	1	0.5	2.5
EX14- 5-10□□	141	51	98	130	40	122	1	0.5	2.5
EX14- 5-14□□	141	51	138	130	40	122	1	0.5	2.5
EX14- 5-19□□	141	51	188	130	40	122	1	0.5	2.5
EX14- 7-10□□	141	71	98	130	60	122	1	0.5	2.5
EX14- 7-14□□	141	71	138	130	60	122	1	0.5	2.5
EX14- 7-19□□	141	71	188	130	60	122	1	0.5	2.5
EX14- 9-10□□	141	91	98	130	80	122	1	0.5	2.5
EX14- 9-14□□	141	91	138	130	80	122	1	0.5	2.5
EX14- 9-19□□	141	91	188	130	80	122	1	0.5	2.5

■ Sonderlängen sind ebenfalls möglich. - ■ Custom length is available.

## EXP - EXPE Maße

## EXP - EXPE Dimensions

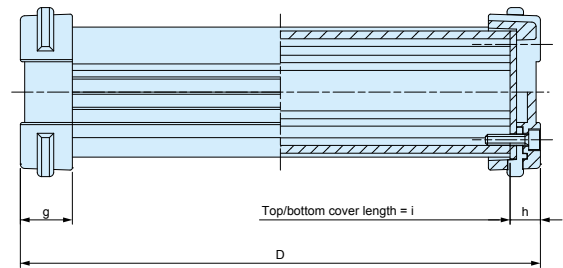
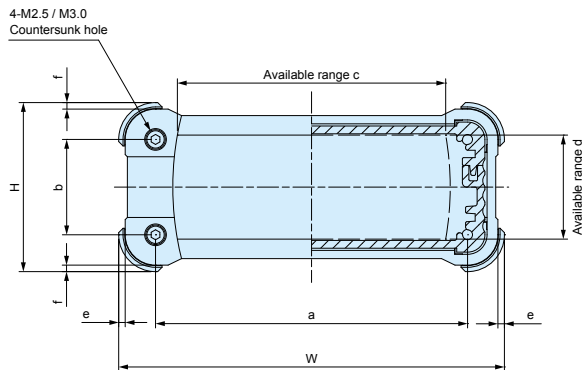

Best-Nr. Product no.	W	H	D	a	b	c	d	e	f	g	h	i
EXP • EXPE 7- 3- 6□□	69	34	60	52	17	41.8	19.6	1.5	1.5	12	7	46
EXP • EXPE 7- 3- 9□□	69	34	87	52	17	41.8	19.6	1.5	1.5	12	7	73
EXP • EXPE 7- 3-11□□	69	34	110	52	17	41.8	19.6	1.5	1.5	12	7	96
EXP • EXPE 7- 4- 6□□	69	44	60	52	27	41.5	29.6	1.5	1.5	12	7	46
EXP • EXPE 7- 4- 9□□	69	44	87	52	27	41.5	29.6	1.5	1.5	12	7	73
EXP • EXPE 7- 4-11□□	69	44	110	52	27	41.5	29.6	1.5	1.5	12	7	96
EXP • EXPE 7- 6- 6□□	69	59	60	52	42	41.2	44.6	1.5	1.5	12	7	46
EXP • EXPE 7- 6- 9□□	69	59	87	52	42	41.2	44.6	1.5	1.5	12	7	73
EXP • EXPE 7- 6-11□□	69	59	110	52	42	41.2	44.6	1.5	1.5	12	7	96
EXP • EXPE 9- 4- 7□□	89	39	70	72	22	61.6	23.5	1.5	1.5	12	7	56
EXP • EXPE 9- 4-10□□	89	39	100	72	22	61.6	23.5	1.5	1.5	12	7	86
EXP • EXPE 9- 4-13□□	89	39	130	72	22	61.6	23.5	1.5	1.5	12	7	116
EXP • EXPE 9- 5- 7□□	89	49	70	72	32	61.3	33.5	1.5	1.5	12	7	56
EXP • EXPE 9- 5-10□□	89	49	100	72	32	61.3	33.5	1.5	1.5	12	7	86
EXP • EXPE 9- 5-13□□	89	49	130	72	32	61.3	33.5	1.5	1.5	12	7	116
EXP • EXPE 9- 6- 7□□	89	64	70	72	47	61	48.5	1.5	1.5	12	7	56
EXP • EXPE 9- 6-10□□	89	64	100	72	47	61	48.5	1.5	1.5	12	7	86
EXP • EXPE 9- 6-13□□	89	64	130	72	47	61	48.5	1.5	1.5	12	7	116
EXP • EXPE12- 4- 9□□	116	41	90	95	20	82.8	23.8	1.75	1.75	16	8	74
EXP • EXPE12- 4-13□□	116	41	130	95	20	82.8	23.8	1.75	1.75	16	8	114
EXP • EXPE12- 4-18□□	116	41	176	95	20	82.8	23.8	1.75	1.75	16	8	160
EXP • EXPE12- 6- 9□□	116	56	90	95	35	83.2	38.8	1.75	1.75	16	8	74
EXP • EXPE12- 6-13□□	116	56	130	95	35	83.2	38.8	1.75	1.75	16	8	114
EXP • EXPE12- 6-18□□	116	56	176	95	35	83.2	38.8	1.75	1.75	16	8	160
EXP • EXPE12- 7- 9□□	116	71	90	95	50	82.8	52.5	1.75	1.75	16	8	74
EXP • EXPE12- 7-13□□	116	71	130	95	50	82.8	52.5	1.75	1.75	16	8	114
EXP • EXPE12- 7-18□□	116	71	176	95	50	82.8	52.5	1.75	1.75	16	8	160
EXP • EXPE15- 5-11□□	151	46	110	130	25	107.4	23.7	1.75	1.75	18	8.5	93
EXP • EXPE15- 5-15□□	151	46	150	130	25	107.4	23.7	1.75	1.75	18	8.5	133
EXP • EXPE15- 5-20□□	151	46	200	130	25	107.4	23.7	1.75	1.75	18	8.5	183
EXP • EXPE15- 6-11□□	151	61	110	130	40	107.4	38.7	1.75	1.75	18	8.5	93
EXP • EXPE15- 6-15□□	151	61	150	130	40	107.4	38.7	1.75	1.75	18	8.5	133
EXP • EXPE15- 6-20□□	151	61	200	130	40	107.4	38.7	1.75	1.75	18	8.5	183
EXP • EXPE15- 8-11□□	151	81	110	130	60	107.4	58.7	1.75	1.75	18	8.5	93
EXP • EXPE15- 8-15□□	151	81	150	130	60	107.4	58.7	1.75	1.75	18	8.5	133
EXP • EXPE15- 8-20□□	151	81	200	130	60	107.4	58.7	1.75	1.75	18	8.5	183
EXP • EXPE15-10-11□□	151	101	110	130	80	107.4	78.7	1.75	1.75	18	8.5	93
EXP • EXPE15-10-15□□	151	101	150	130	80	107.4	78.7	1.75	1.75	18	8.5	133
EXP • EXPE15-10-20□□	151	101	200	130	80	107.4	78.7	1.75	1.75	18	8.5	183

# EXW Maße

# EXW Dimensions

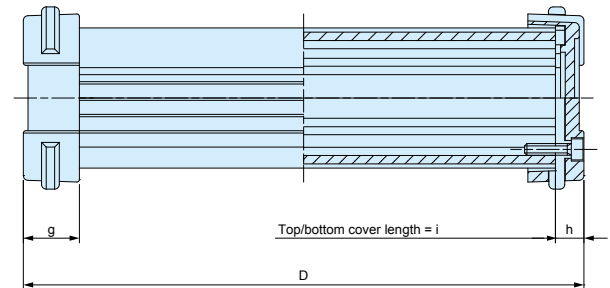
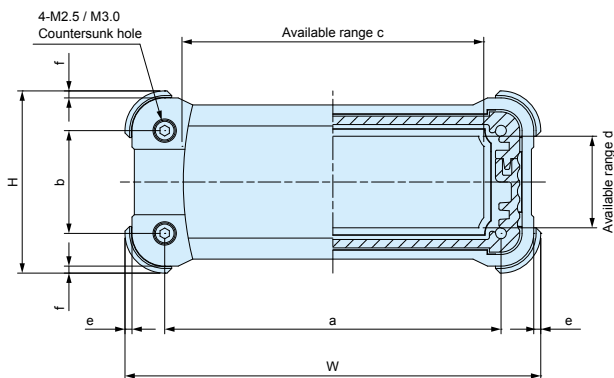

Best-Nr. Product no.	W	H	D	a	b	c	d	e	f	g	h	i
EXW 7- 3- 6□□	69	34	58	52	17	46	16	1.5	1.5	12	6	46
EXW 7- 3- 9□□	69	34	85	52	17	46	16	1.5	1.5	12	6	73
EXW 7- 3-11□□	69	34	108	52	17	46	16	1.5	1.5	12	6	96
EXW 7- 4- 6□□	69	44	58	52	27	46	26	1.5	1.5	12	6	46
EXW 7- 4- 9□□	69	44	85	52	27	46	26	1.5	1.5	12	6	73
EXW 7- 4-11□□	69	44	108	52	27	46	26	1.5	1.5	12	6	96
EXW 7- 6- 6□□	69	59	58	52	42	46	41	1.5	1.5	12	6	46
EXW 7- 6- 9□□	69	59	85	52	42	46	41	1.5	1.5	12	6	73
EXW 7- 6-11□□	69	59	108	52	42	46	41	1.5	1.5	12	6	96
EXW 9- 4- 7□□	89	39	69	72	22	65.8	20	1.5	1.5	12	6.5	56
EXW 9- 4-10□□	89	39	99	72	22	65.8	20	1.5	1.5	12	6.5	86
EXW 9- 4-13□□	89	39	129	72	22	65.8	20	1.5	1.5	12	6.5	116
EXW 9- 5- 7□□	89	49	69	72	32	65.8	30	1.5	1.5	12	6.5	56
EXW 9- 5-10□□	89	49	99	72	32	65.8	30	1.5	1.5	12	6.5	86
EXW 9- 5-13□□	89	49	129	72	32	65.8	30	1.5	1.5	12	6.5	116
EXW 9- 6- 7□□	89	64	69	72	47	65.8	45	1.5	1.5	12	6.5	56
EXW 9- 6-10□□	89	64	99	72	47	65.8	45	1.5	1.5	12	6.5	86
EXW 9- 6-13□□	89	64	129	72	47	65.8	45	1.5	1.5	12	6.5	116
EXW12- 4- 9□□	116	41	88	95	20	89.6	18	1.75	1.75	16	7	74
EXW12- 4-13□□	116	41	128	95	20	89.6	18	1.75	1.75	16	7	114
EXW12- 4-18□□	116	41	174	95	20	89.6	18	1.75	1.75	16	7	160
EXW12- 6- 9□□	116	56	88	95	35	89.6	33	1.75	1.75	16	7	74
EXW12- 6-13□□	116	56	128	95	35	89.6	33	1.75	1.75	16	7	114
EXW12- 6-18□□	116	56	174	95	35	89.6	33	1.75	1.75	16	7	160
EXW12- 7- 9□□	116	71	88	95	50	89.6	48	1.75	1.75	16	7	74
EXW12- 7-13□□	116	71	128	95	50	89.6	48	1.75	1.75	16	7	114
EXW12- 7-18□□	116	71	174	95	50	89.6	48	1.75	1.75	16	7	160
EXW15- 5-11□□	151	46	107	130	25	103.4	18.2	1.75	1.75	18	7	93
EXW15- 5-15□□	151	46	147	130	25	103.4	18.2	1.75	1.75	18	7	133
EXW15- 5-20□□	151	46	197	130	25	103.4	18.2	1.75	1.75	18	7	183
EXW15- 6-11□□	151	61	107	130	40	103.4	33.2	1.75	1.75	18	7	93
EXW15- 6-15□□	151	61	147	130	40	103.4	33.2	1.75	1.75	18	7	133
EXW15- 6-20□□	151	61	197	130	40	103.4	33.2	1.75	1.75	18	7	183
EXW15- 8-11□□	151	81	107	130	60	103.4	53.2	1.75	1.75	18	7	93
EXW15- 8-15□□	151	81	147	130	60	103.4	53.2	1.75	1.75	18	7	133
EXW15- 8-20□□	151	81	197	130	60	103.4	53.2	1.75	1.75	18	7	183
EXW15-10-11□□	151	101	107	130	80	103.4	73.2	1.75	1.75	18	7	93
EXW15-10-15□□	151	101	147	130	80	103.4	73.2	1.75	1.75	18	7	133
EXW15-10-20□□	151	101	197	130	80	103.4	73.2	1.75	1.75	18	7	183

# Profilübersicht

EXP - EXPE - EXW - EX Ober- und Unterschale

# Cross-section View

EXP - EXPE - EXW - EX top / bottom covers

EXP • EXPE • EXW 7-3-□  
EX 6-3-□

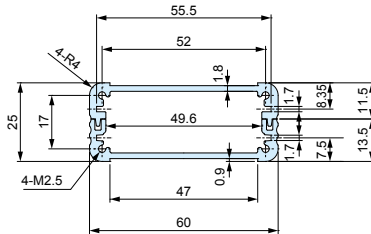

EXP • EXPE • EXW 7-4-□  
EX 6-4-□

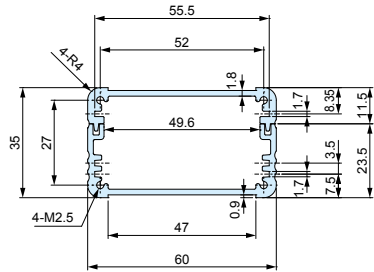

EXP • EXPE • EXW 7-6-□  
EX 6-5-□

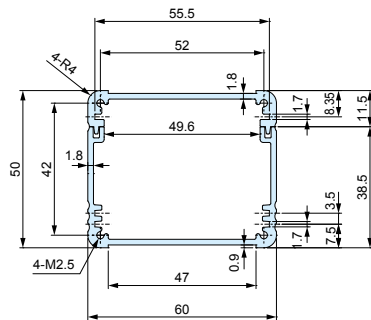

EXP • EXPE • EXW 9-4-□  
EX 8-3-□

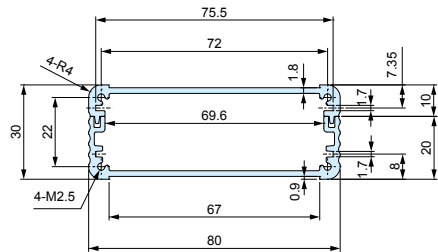

EXP • EXPE • EXW 9-5-□  
EX 8-4-□

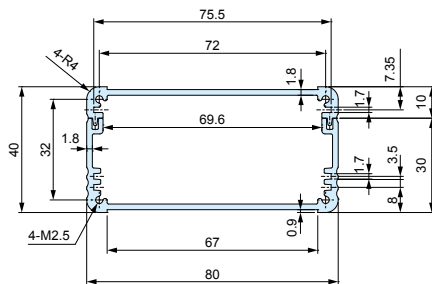

EXP • EXPE • EXW 9-6-□  
EX 8-6-□

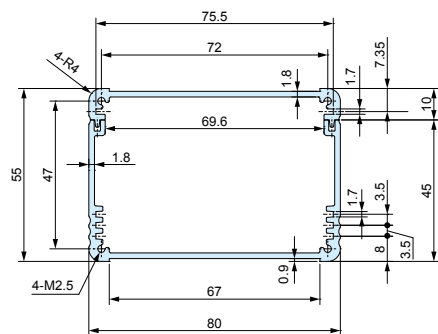

EXP • EXPE • EXW 12-4-□  
EX 11-3-□

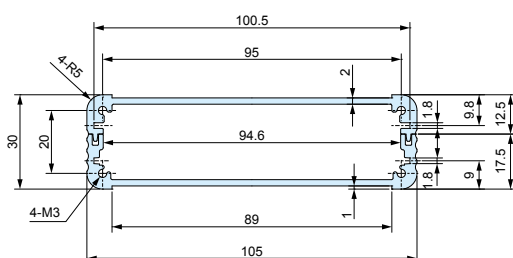

EXP • EXPE • EXW 12-6-□  
EX 11-5-□

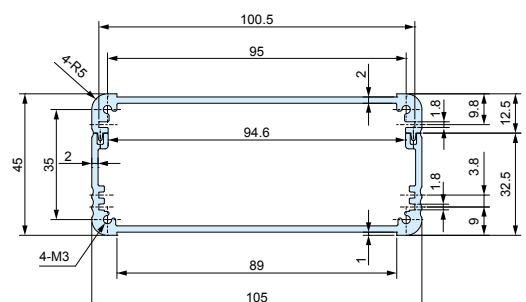

EXP • EXPE • EXW 12-7-□  
EX 11-6-□

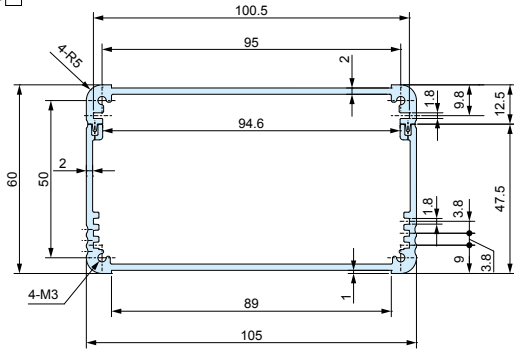

EXP • EXPE • EXW 15-5-□  
EX 14-4-□

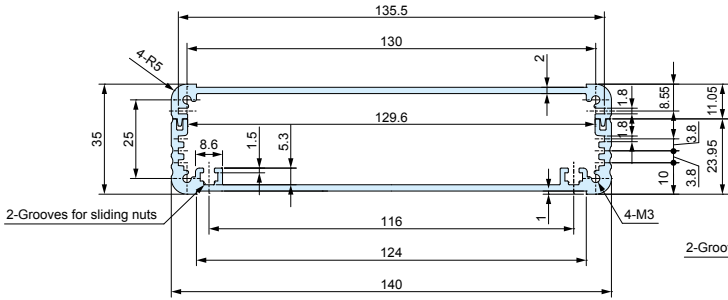

EXP • EXPE • EXW 15-6-□  
EX 14-5-□

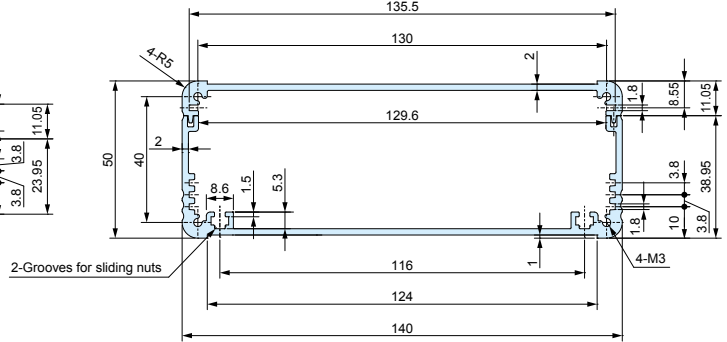

EXP • EXPE • EXW 15-8-□  
EX 14-7-□

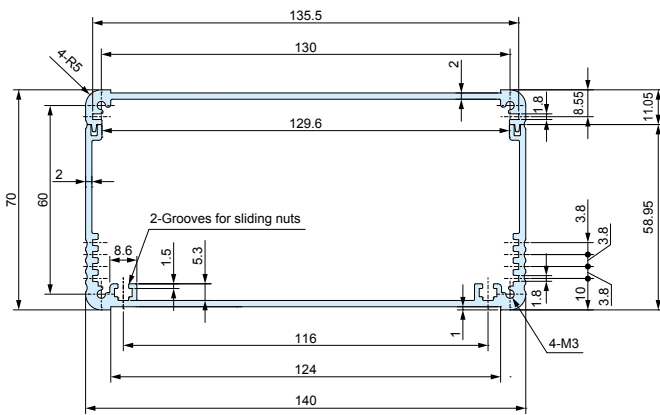

EXP • EXPE • EXW 15-10-□  
EX 14-9-□

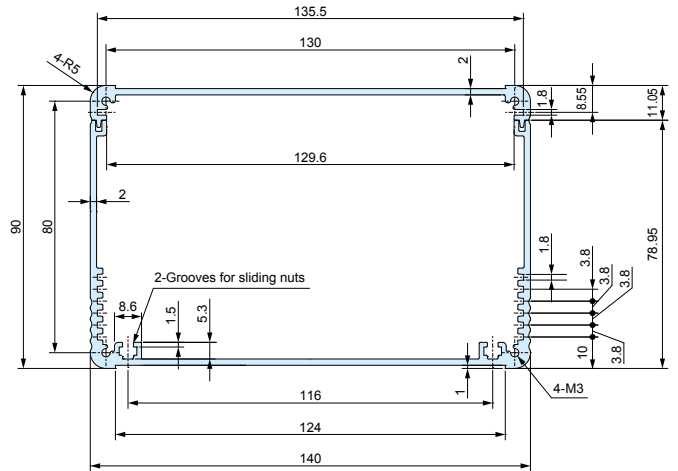

**MT-3N - Zubehör** (optional erhältlich)  
Schiebemutter für EXP - EXPE - EXW - EX

**MT-3N - Accessories** (optional parts)  
Sliding Nut for EXP - EXPE - EXW - EX

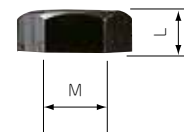
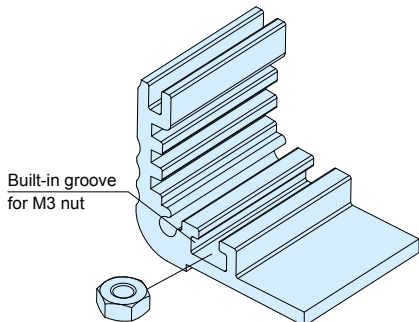

Bestellnummer / Maße  
Product no. / Dimensions

Best-Nr. Product no.	M	L	Material	Oberfläche Finish	Stk./Verpackung Pack of
MT-3N	3	2.4	Stahl Steel	Schwarz chromatiert Black trivalent chromate	50

- Schiebemutter kann bei Profilen  $\geq 140\text{mm}$  verwendet werden.
- Sliding nut can be used on 140mm and larger bottom covers.

## EXP - EXPE Außenrahmen / Frontplatte

## EXP - EXPE exterior frame / panel

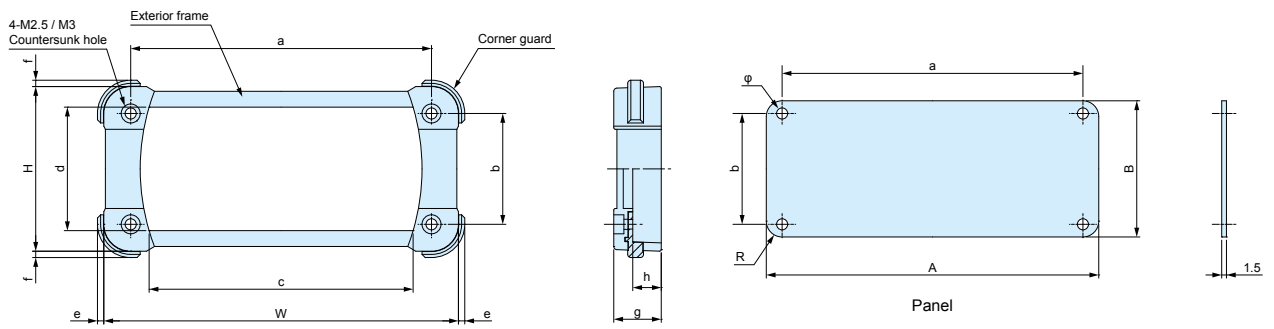

Best-Nr. Product no.	W	H	a	b	c	d	e	f	g	h	A	B	φ	R
EXP / EXPE 7- 3-□	66	31	52	17	41.8	21	1.5	1.5	12	6.5	60.6	23.2	3	3.5
EXP / EXPE 7- 4-□	66	41	52	27	41.5	29.6	1.5	1.5	12	6.5	60.6	33.2	3	3.5
EXP / EXPE 7- 6-□	66	56	52	42	41.2	44.6	1.5	1.5	12	6.5	60.6	48.2	3	3.5
EXP / EXPE 9- 4-□	86	36	72	22	61.6	24	1.5	1.5	12	6.5	80.6	28.8	3	3.5
EXP / EXPE 9- 5-□	86	46	72	32	61.3	34	1.5	1.5	12	6.5	80.6	38.8	3	3.5
EXP / EXPE 9- 6-□	86	61	72	47	61	49	1.5	1.5	12	6.5	80.6	53.8	3	3.5
EXP / EXPE12- 4-□	112.5	37.5	95	20	82.8	23.8	1.75	1.75	16	9.5	105.6	28.6	3.5	4.5
EXP / EXPE12- 6-□	112.5	52.5	95	35	83.2	38.8	1.75	1.75	16	9.5	105.6	43.6	3.5	4.5
EXP / EXPE12- 7-□	112.5	67.5	95	50	82.8	53.8	1.75	1.75	16	9.5	105.6	58.6	3.5	4.5
EXP / EXPE15- 5-□	147.5	42.5	130	25	118	28.8	1.75	1.75	18	11	140.6	33.6	3.5	4.5
EXP / EXPE15- 6-□	147.5	57.5	130	40	117.8	43.8	1.75	1.75	18	11	140.6	48.6	3.5	4.5
EXP / EXPE15- 8-□	147.5	77.5	130	60	116.3	63.8	1.75	1.75	18	11	140.6	68.6	3.5	4.5
EXP / EXPE15-10-□	147.5	97.5	130	80	115.7	83.8	1.75	1.75	18	11	140.6	88.6	3.5	4.5

## EXW Frontplatten

## EXW Panel

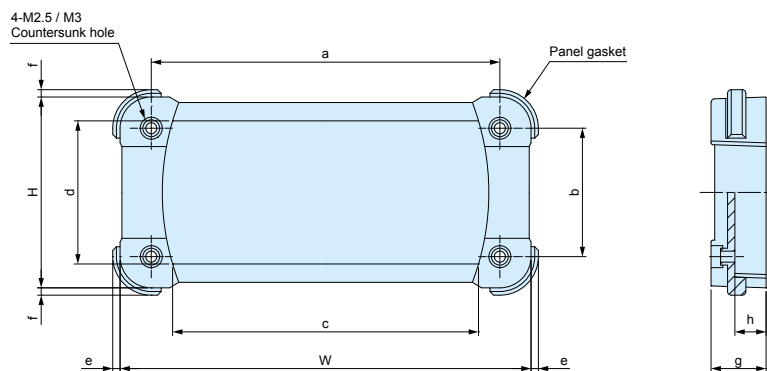

Best-Nr. Product no.	W	H	a	b	c	d	e	f	g	h
EXW 7- 3-□	66	31	52	17	41.7	21.8	1.5	1.5	12	6
EXW 7- 4-□	66	41	52	27	41.2	31.8	1.5	1.5	12	6
EXW 7- 6-□	66	56	52	42	41.2	45.8	1.5	1.5	12	6
EXW 9- 4-□	86	36	72	22	61.5	24.8	1.5	1.5	12	5.5
EXW 9- 5-□	86	46	72	32	61	34.8	1.5	1.5	12	5.5
EXW 9- 6-□	86	61	72	47	60.8	49.8	1.5	1.5	12	5.5
EXW12- 4-□	112.5	37.5	95	20	81.9	27.3	1.75	1.75	16	9
EXW12- 6-□	112.5	52.5	95	35	82.2	42.3	1.75	1.75	16	9
EXW12- 7-□	112.5	67.5	95	50	82.3	54.3	1.75	1.75	16	9
EXW15- 5-□	147.5	42.5	130	25	118.8	29.3	1.75	1.75	18	11
EXW15- 6-□	147.5	57.5	130	40	117.8	44.3	1.75	1.75	18	11
EXW15- 8-□	147.5	77.5	130	60	116.3	64.3	1.75	1.75	18	11
EXW15-10-□	147.5	97.5	130	80	116.6	84.3	1.75	1.75	18	11

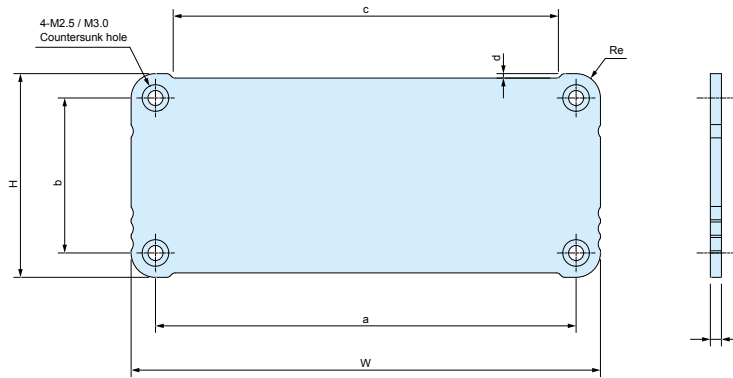

Best-Nr. Product no.	W	H	a	b	c	d	e	t
EX 6-3-□	60.6	25.6	52	17	45.2	0.9	4.3	2
EX 6-4-□	60.6	35.6	52	27	45.2	0.9	4.3	2
EX 6-5-□	60.6	50.6	52	42	45.2	0.9	4.3	2
EX 8-3-□	80.6	30.6	72	22	65.2	0.9	4.3	2
EX 8-4-□	80.6	40.6	72	32	65.2	0.9	4.3	2
EX 8-6-□	80.6	55.6	72	47	65.2	0.9	4.3	2
EX11-3-□	106	31	95	20	87	1	5.5	2.5
EX11-5-□	106	46	95	35	87	1	5.5	2.5
EX11-6-□	106	61	95	50	87	1	5.5	2.5
EX14-4-□	141	36	130	25	122	1	5.5	2.5
EX14-5-□	141	51	130	40	122	1	5.5	2.5
EX14-7-□	141	71	130	60	122	1	5.5	2.5
EX14-9-□	141	91	130	80	122	1	5.5	2.5

**EXEG-2.5 Zubehör** (optional erhältlich)  
EMV-Dichtung für EXPE-Serie



**EXEG-2.5 Accessories** (optional parts)  
EMC shielding fabric-over-foam gasket for EXPE

- EMV-Dichtung für EXPE Serie.
- EMC shielding fabric-over-foam gasket for EXPE series.



**Bestellnummer / Maße**  
Product no. / Dimensions

Best-Nr. Product no.	Φ	Material	Farbe Color	Verkaufseinheit Sales unit
EXEG-2.5	2.5	Drahtgeflechtdichtung • TPE	Metallic Grau	500mm x 1 Stück
EXEG-2.5	2.5	Wire mesh gasket • TPE	Metallic gray	500mm x 1 pc

Längentoleranz = +/- 10% - Length tolerance = +/- 10%

**SGK-2.5 Silikondichtung für Serie EXW**

**SGK-2.5 Silicone gasket for EXW**

- Dichtung für EXW Serie.
- Sealing gasket for EXW series.

**Bestellnummer / Maße**  
Product no. / Dimensions

Best-Nr. Product no.	Φ	Material	Farbe Color	Verkaufseinheit Sales unit
SGK-2.5	2.5	Silikon	Hellgrau	1000mm x 1 Stück
SGK-2.5	2.5	Silicone	White gray	1000mm x 1 pc

Längentoleranz = +/- 10% - Length tolerance = +/- 10%







## Serie EXH

Kühlkörper Aluminium Gehäuse

## EXH Series

Heat-sink aluminium enclosure

Das Aluminiumgehäuse der Serie EXH besitzt einen hoch effizienten Kühlkörperdeckel. Durch gute Entwärmungseigenschaften geeignet als Lüfterloser PC, Verstärkergehäuse oder Netzteilgehäuse. Verfügbar in 30 verschiedenen Größen.

EXH series is an aluminium enclosure with a highly efficient heat-sink top cover. Suitable to be used as fanless PC, power amplifier, and power supply box where heat dissipation is required. Wide range, 30 different sizes available.

**Wellenförmige Kühlkörperrippen sorgen für eine maximale Entwärmung!**  
**Waved surface heat-sink fins for maximum cooling performance!**

- Jede Kühlkörperrippe besitzt eine wellenförmige Geometrie für eine maximale Wärmeabgabe.
- Each heat-sink fin has a waved surface construction for maximum cooling performance.

Waved Surface



### BEISPIEL BAUTEILENTWÄRMUNG - HEAT DISSIPATION EXAMPLE

- Die Serie EXH besitzt im Kühlkörperdeckel Nuten zur Aufnahme von M3 Schiebemuttern. Es ist ebenfalls möglich eine Verbindung von der Wärmequelle zum Kühlkörperprofil zu realisieren, um eine bessere Bauteilkühlung zu erreichen.
- EXH series has grooves to put M3 nuts inside its heat-sink cover. It is possible to construct a heat conduction route from your heat source to heat-sink cover easily for better heat dissipation performance.

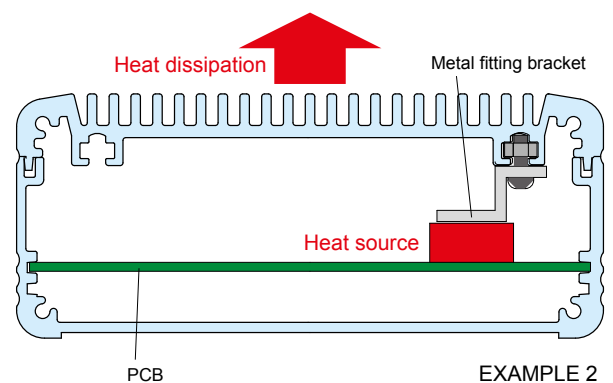
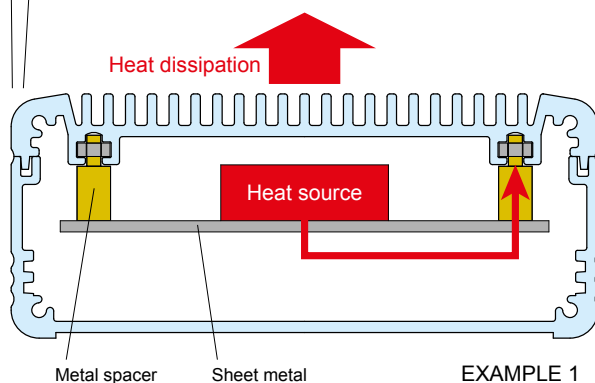

# ANWENDUNGSBEISPIELE - APPLICATION EXAMPLES

## LÜFTERLOSER INDUSTRIE PC INDUSTRIAL FANLESS PC



## LEISTUNGSVERSTÄRKER POWER AMPLIFIER



# BEARBEITUNGSBEISPIELE - CUSTOMIZATION EXAMPLES

## CNC BEARBEITUNG AM KÜHLKÖRPERPROFIL CNC MACHINING on HEAT-SINK COVER

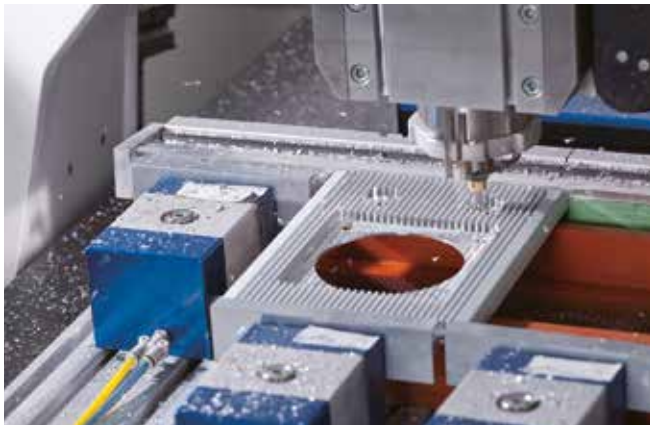

Kühlkörperprofile können mit unseren CNC-Maschinen bearbeitet werden.

Heat-sink plates can be customized with our high speed CNC machines.

## STIFT-KÜHLKÖRPERBEARBEITUNG PIN TYPE FIN CUSTOMIZATION



Stift-Kühlkörper für eine bessere Entwärmung können durch Fräsbearbeitung realisiert werden.

Pin type heat-sink fin can be customized for better cooling performance.

## LÜFTUNGSSCHLITZE - VENTILATION SLITS



Gefräster Kühlkörperdeckel mit Lüftungsschlitzen für eine bessere Entlüftung / Entwärmung.

Heat-sink plate can be customized as ventilation slit for better cooling / ventilation performance.

## FARBIGES ELOXAL - COLOR ANODIZING



Verschiedene Farben wie z.B. blau, rot, orange, grün, lila können nach Ihren Vorgaben eloxiert werden.

■ Nicht alle Farben und Schattierungen können eloxiert werden.

Various colors, such as blue, red, orange, green or purple can be anodized as per your requirements.

■ Not all colors and shades of colors are possible.

**Technische Daten**

Schutzklasse: IP40

**Technical Data**

Protection class: IP40



## Serie EXH

Kühlkörper Aluminium Gehäuse



## EXH Series

Heat-sink aluminium enclosure

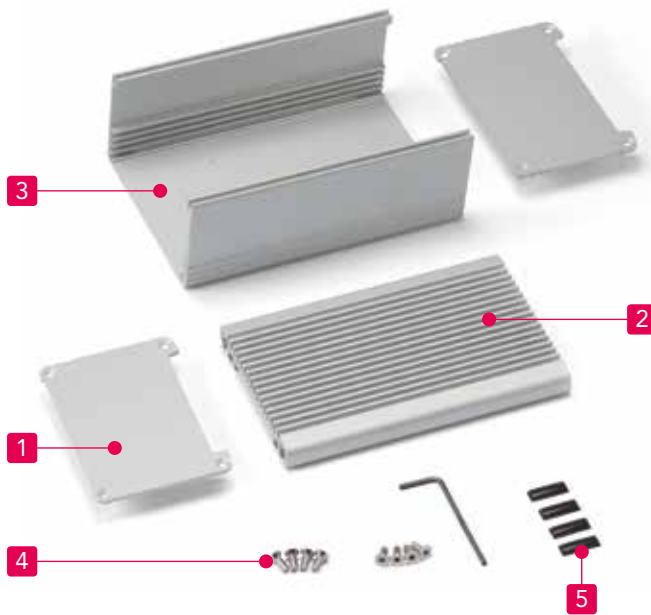

- Aluminium Gehäuse mit hoch effizientem Kühlkörperdeckel.
- Geeignet als lüfterloser PC, Verstärkergehäuse oder Netzteilgehäuse.
- Verfügbar in 30 verschiedenen Größen und 4 Farbkombinationen.
- Integrierte Führungsnuten im Kühlkörperdeckel und Bodenprofil zur Aufnahme von M3 – Schiebemuttern.
- Aluminium enclosure equipped with a highly efficient heat-sink top cover.
- Suitable to be used as a fanless PC, power amplifier, power supply etc. where heat dissipation is required.
- Selectable in 30 different sizes and 4 color types.
- Grooves are built into the heat-sink top cover and bottom frame for M3 nut insertion.

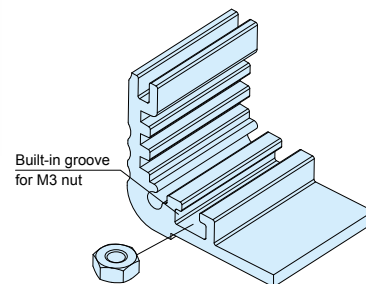
**Komponenten**

Nr.	Bezeichnung	Stück	Material	Farbe / Oberfläche
1	Frontplatten	2	Aluminium A1050P	silber • schwarz / eloxiert
2	Kühlkörperdeckel	1	Aluminiumprofil A6063S-T5	silber • schwarz / eloxiert
3	Bodenprofil	1	Aluminiumprofil A6063S-T5	silber • schwarz / eloxiert
4	Schraube	8	Edelstahl	unbehandelt
5	GummifüÙe	4	Polyurethan	schwarz

**Components**

No.	Part name	Pcs	Material	Color / Finish
1	Panel	2	Aluminium A1050P	Silver • Black / Anodized
2	Heat-sink top cover	1	Extruded aluminium A6063S-T5	Silver • Black / Anodized
3	Bottom frame	1	Extruded aluminium A6063S-T5	Silver • Black / Anodized
4	Screw	8	Stainless steel	Unfinished
5	Rubber feet	4	Polyurethane	Black

**Farbvarianten - Color Types**

Farbcode Color code	SS silber / silber SS Silver / Silver	SB silber / schwarz SB Silver / Black	BS schwarz / silber BS Black / Silver	BB schwarz / schwarz BB Black / Black
Farbe Color				

# EXH Maße

# EXH Dimensions

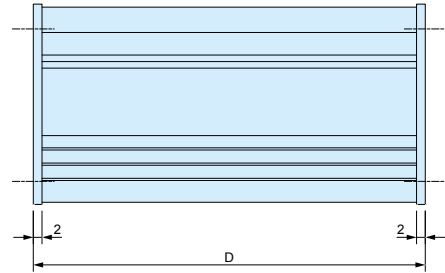
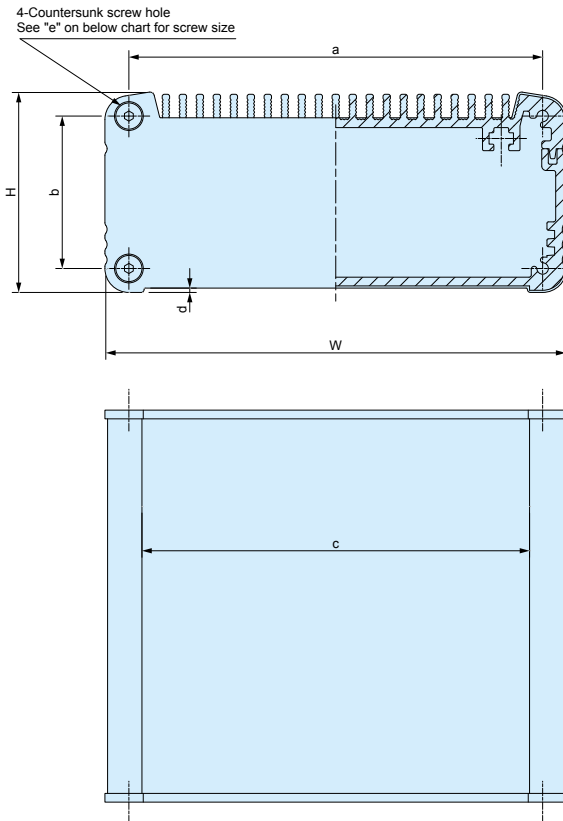

Included screws  
EXH8 series : M2.5-8 x 8 pcs  
EXH11 and EXH14 series : M3-8 x 8 pcs  
※Hexagonal wrench included.

- ※Thermal resistance test condition
- Ambient air cooling
  - Heat-sink fins are set perpendicular to the ground with temperature at 60°C.
  - Anodized aluminium extrusion
  - Heat source is applied on the opposite side (inner side) of the fins.

## Bestellnummer / Maße Product no. / Dimensions

■ Bitte vervollständigen Sie die Bestellnummer mit dem Farbcode am Ende.  
■ Please suffix color code at the end of the product number.

Best-Nr. Product no.	W	H	D	a	b	c	d	e	※Thermal resistance rate (°C/W)
EXH 8-3- 6□□	80.6	30.7	60	72	22	67	0.9	2.5	7.32
EXH 8-3- 9□□	80.6	30.7	90	72	22	67	0.9	2.5	5.65
EXH 8-3-12□□	80.6	30.7	120	72	22	67	0.9	2.5	4.72
EXH 8-4- 6□□	80.6	40.7	60	72	32	67	0.9	2.5	7.32
EXH 8-4- 9□□	80.6	40.7	90	72	32	67	0.9	2.5	5.65
EXH 8-4-12□□	80.6	40.7	120	72	32	67	0.9	2.5	4.72
EXH 8-6- 6□□	80.6	55.7	60	72	47	67	0.9	2.5	7.32
EXH 8-6- 9□□	80.6	55.7	90	72	47	67	0.9	2.5	5.65
EXH 8-6-12□□	80.6	55.7	120	72	47	67	0.9	2.5	4.72
EXH11-3- 8□□	106	31.1	78	95	20	89	1	3	4.82
EXH11-3-12□□	106	31.1	118	95	20	89	1	3	3.72
EXH11-3-16□□	106	31.1	164	95	20	89	1	3	3.03
EXH11-5- 8□□	106	46.1	78	95	35	89	1	3	4.82
EXH11-5-12□□	106	46.1	118	95	35	89	1	3	3.72
EXH11-5-16□□	106	46.1	164	95	35	89	1	3	3.03
EXH11-6- 8□□	106	61.1	78	95	50	89	1	3	4.82
EXH11-6-12□□	106	61.1	118	95	50	89	1	3	3.72
EXH11-6-16□□	106	61.1	164	95	50	89	1	3	3.03
EXH14-4-10□□	141	36.1	97	130	25	124	1	3	3.4
EXH14-4-14□□	141	36.1	137	130	25	124	1	3	2.75
EXH14-4-19□□	141	36.1	187	130	25	124	1	3	2.27
EXH14-5-10□□	141	51.1	97	130	40	124	1	3	3.4
EXH14-5-14□□	141	51.1	137	130	40	124	1	3	2.75
EXH14-5-19□□	141	51.1	187	130	40	124	1	3	2.27
EXH14-7-10□□	141	71.1	97	130	60	124	1	3	3.4
EXH14-7-14□□	141	71.1	137	130	60	124	1	3	2.75
EXH14-7-19□□	141	71.1	187	130	60	124	1	3	2.27
EXH14-9-10□□	141	91.1	97	130	80	124	1	3	3.4
EXH14-9-14□□	141	91.1	137	130	80	124	1	3	2.75
EXH14-9-19□□	141	91.1	187	130	80	124	1	3	2.27

Profilübersicht - Profiles overview

8-3-□

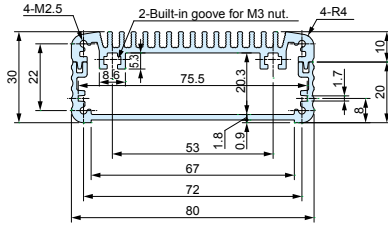

8-4-□

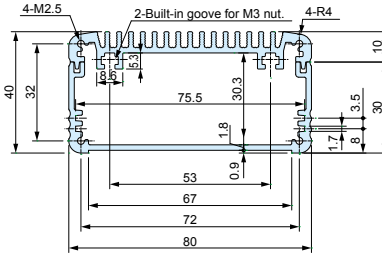

8-6-□

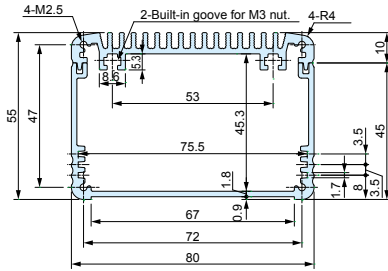

11-3-□

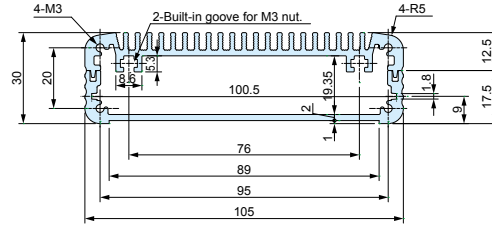

11-5-□

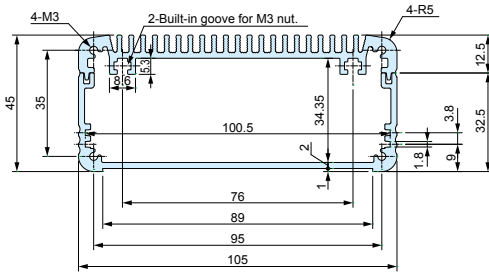

11-6-□

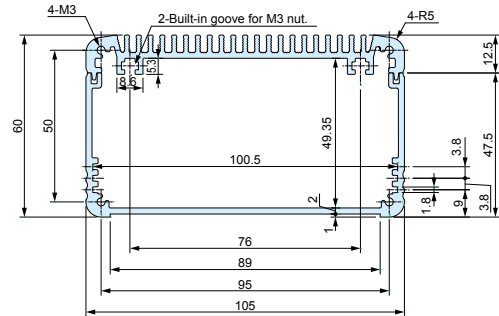

14-4-□

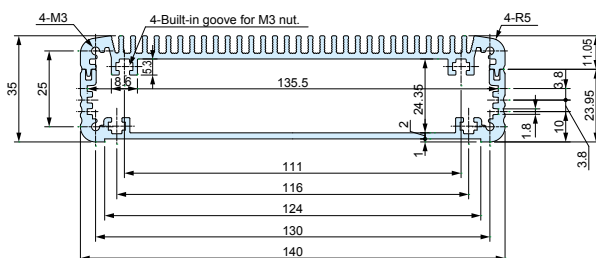

14-5-□

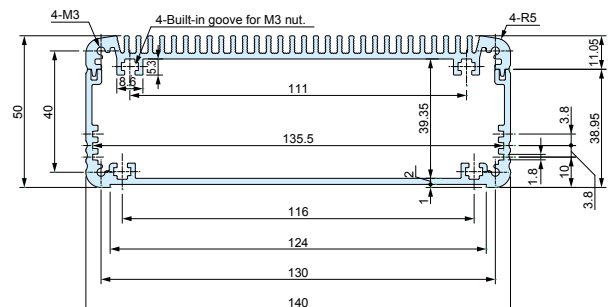

14-7-□

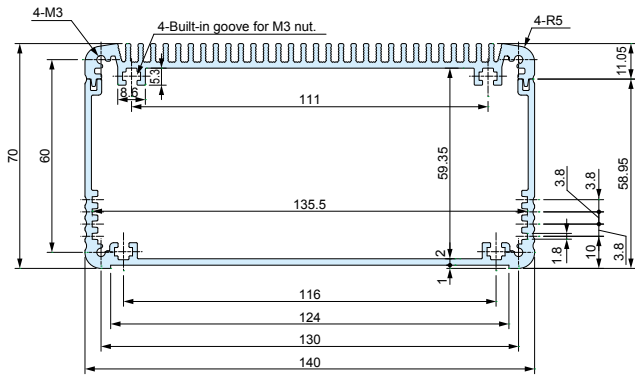

14-9-□

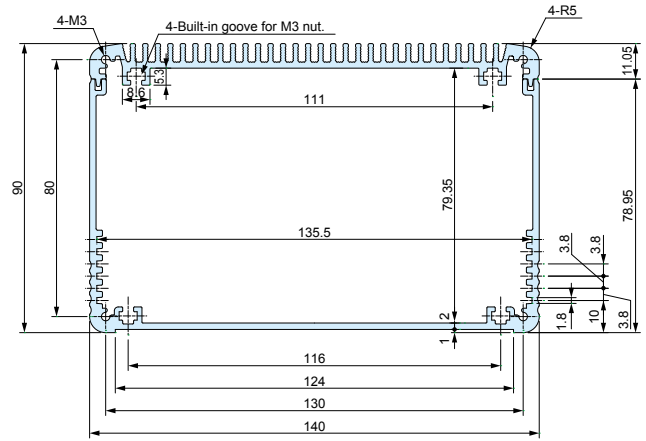

EXH Frontplatten

EXH Panel

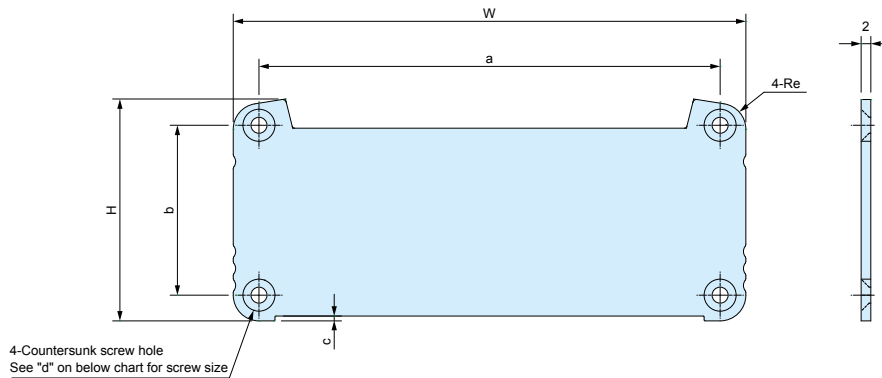

Best-Nr. Product no.	W	H	a	b	c	d	e
EXH 8-3-□	80.6	30.7	72	22	0.9	2.5	4.3
EXH 8-4-□	80.6	40.7	72	32	0.9	2.5	4.3
EXH 8-6-□	80.6	55.7	72	47	0.9	2.5	4.3
EXH11-3-□	106	31.1	95	20	1	3	5.5
EXH11-5-□	106	46.1	95	35	1	3	5.5
EXH11-6-□	106	61.1	95	50	1	3	5.5
EXH14-4-□	141	36.1	130	25	1	3	5.5
EXH14-5-□	141	51.1	130	40	1	3	5.5
EXH14-7-□	141	71.1	130	60	1	3	5.5
EXH14-9-□	141	91.1	130	80	1	3	5.5

MT-3N Zubehör (optional erhältlich)  
Schiebemutter für EXH

MT-3N Accessories (optional parts)  
Sliding nut for EXH

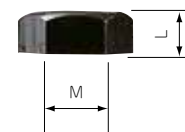
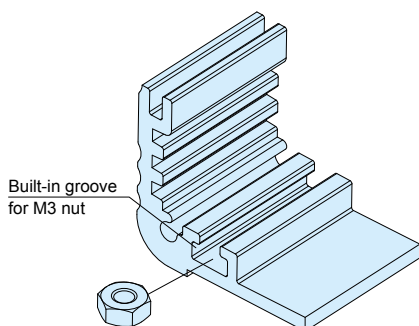

Bestellnummer / Maße  
Product no. / Dimensions

Best-Nr. Product no.	M	L	Material	Oberfläche Finish	Verpackungseinheit Pack of
MT-3N	3	2.4	Stahl	Schwarz chromatiert	50
MT-3N	3	2.4	Steel	Black trivalent chromate	50

- Schiebemutter kann für alle EXH Kühlkörperdeckel und EXH14 Bodenprofile eingesetzt werden.
- Sliding nut can be used on all EXH heat-sink top covers and EXH14 bottom frames.